

# Fairfax - Swan Lake (Linn County) 161 kV Transmission Line Project

## PROJECT OVERVIEW

ITC Midwest (ITC) is planning to build a new 161 kV (161,000 volt) electric transmission line that travels through Linn and Johnson counties from the Fairfax Substation at the south edge of Fairfax, owned by ITC Midwest, to the Swan Lake Substation, owned by CIPCO, near North Liberty.

In Linn County, the proposed 161 kV line will be double-circuited with the existing 345 kV (345,000 volt) line near Fairfax, traveling mostly westward for approximately 2 miles. In other words, the new 161 kV line will be added to the same structures as the existing 345 kV line to reduce the need for a new transmission corridor across privately owned land. At this point, the proposed line will be constructed as a 161 kV single circuit running southwest and then mostly south for 3.4 miles into Johnson County.

Altogether through the two counties, the proposed line is approximately 17 miles in length. The segment in Linn County is about 5.4 miles long. The final route may change and will be determined when easement negotiations with landowners are completed and the Iowa Utilities Board has approved the project. (Please see map of the proposed line route corridor in Linn County on the back.)

### ***Why is this line needed?***

This line build is part of ITC Midwest's continuing efforts to improve reliability of the electric transmission system and better serve current and future needs of electric consumers. The Cedar Rapids – North Liberty corridor continues to see increases in electrical demand, which necessitates increased electric transmission capacity. The configuration of the existing transmission system in the area limits the ability to re-route electricity to customers during planned outages (when a line needs to be taken out of service for maintenance) and unplanned outages (such as an outage resulting from a severe storm). This new 161 kV line is needed to ensure the system can remain reliable during planned and unplanned system outages. Connecting an additional 161 kV line to the transmission grid in this area ensures long-term reliability can be maintained as well as providing increased system resiliency to better withstand severe weather.

**The Fairfax - Swan Lake project will provide important benefits and drive value for electric consumers. When completed, this transmission line will:**

- Increase transmission infrastructure to **improve system reliability**
- Enhance grid resilience to better **withstand extreme weather**
- **Better serve current and future needs** through increased system capacity
- **Reduce electric system congestion** and improve grid efficiency

### ***Whose approval is required to build this line?***

The Iowa Utilities Board (IUB) grants regulatory approvals, called franchises, to Iowa utilities seeking to build transmission lines in the state. As part of its review process, the IUB reviews many aspects of the project such as the need for the line and the proposed route. The IUB has very clear criteria and a clear process for utilities to follow to request a franchise.

### ***What is being done to ensure this line will be safe?***

This line will be designed to meet and even exceed the National Electrical Safety Code (NESC), the nationally-recognized design standard in the United States, as well as the Iowa Electrical Safety Code. Among other things, these codes require construction to meet clearance requirements and withstand extreme weather conditions. As the line owner, ITC Midwest will make sure that the line is clear of trees and other vegetation.



**FOR THE GREATER GRID.**

**ITC MIDWEST** 123 Fifth Street SE, Cedar Rapids, IA 52401  
Locations: Albert Lea, Des Moines, Dubuque, Iowa City, Lakefield, Perry  
**877.ITC.ITC9** (877.482.4829) | [www.itc-holdings.com](http://www.itc-holdings.com)

## Fairfax - Swan Lake (Linn County) 161 kV Transmission Line Project

### What is ITC Midwest doing to minimize impact on landowners and current land uses?

ITC Midwest seeks to minimize the impact of the line on existing land uses. The company is committed to protecting the environment and will fully compensate landowners for any damages that occur during the construction process.

Where possible, this new line will be double-circuited with existing transmission lines to mitigate the need for a new transmission corridor across privately owned land. To minimize the footprint of the line, ITC Midwest plans to use steel monopoles.

### How will ITC Midwest work with landowners?

Under Iowa law, ITC Midwest cannot negotiate for easements until after the Iowa Utilities Board holds a public information meeting. For this project, the Linn County meeting was held in Cedar Rapids on September 14, 2023. In the coming weeks, ITC Midwest representatives will begin meeting with affected landowners in the proposed corridor to explain the process and their rights, and ultimately, to begin negotiations to secure voluntary easements. Landowners are compensated for permitting ITC Midwest to secure an easement on their property. ITC Midwest understands and appreciates the impact that new line construction has on landowners and pledges to treat *all* landowners with the utmost respect during this important process.

### Fairfax - Swan Lake project proposed line corridor route in Linn County

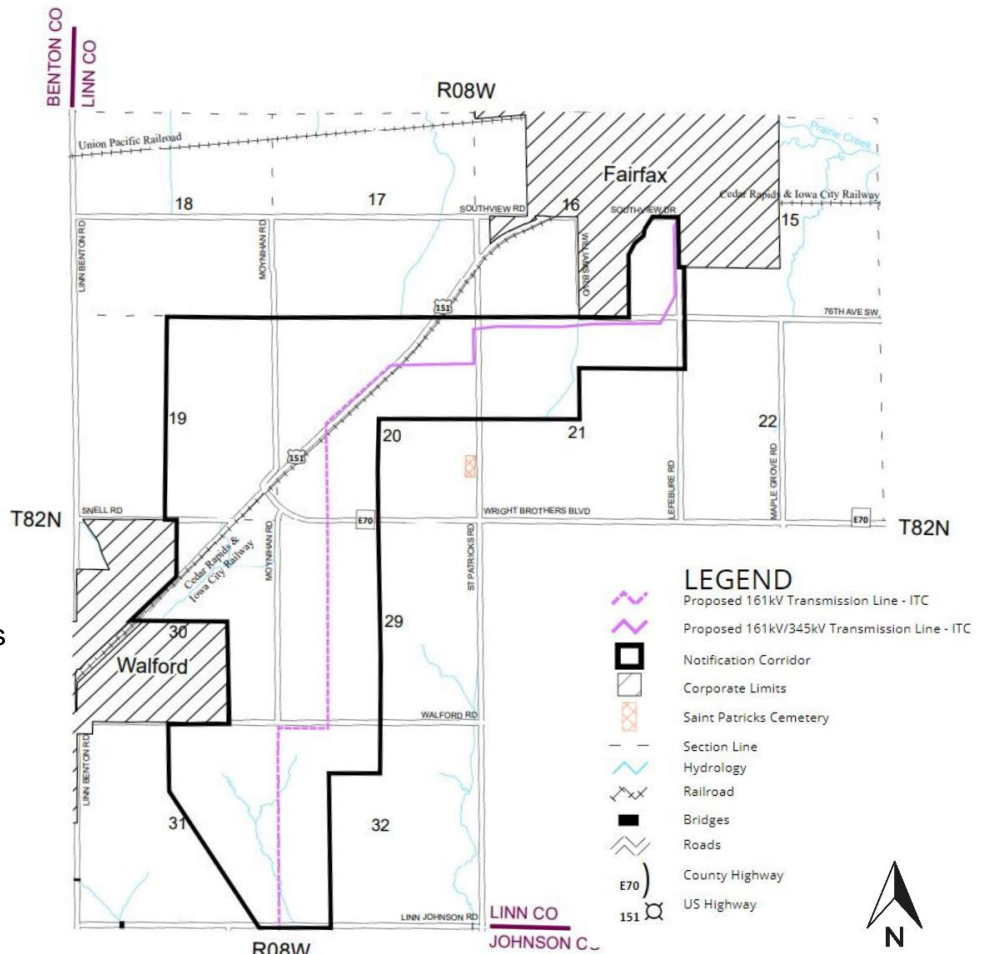

### Project Contacts

If you have questions, you can contact ITC using our toll-free customer line at 1-877-482-4829. Once construction begins, Bob Dueker and Cory Turenne will be ITC Midwest’s project leads.



**Bob Dueker**  
Project Manager  
(319) 297-6788  
[rducker@itctransco.com](mailto:rducker@itctransco.com)



**Cory Turenne**  
Field Supervisor  
(262) 689-3033  
[cturenne@itctransco.com](mailto:cturenne@itctransco.com)